

**LONDON  
VICTORIA  
GROUPS** 🏠

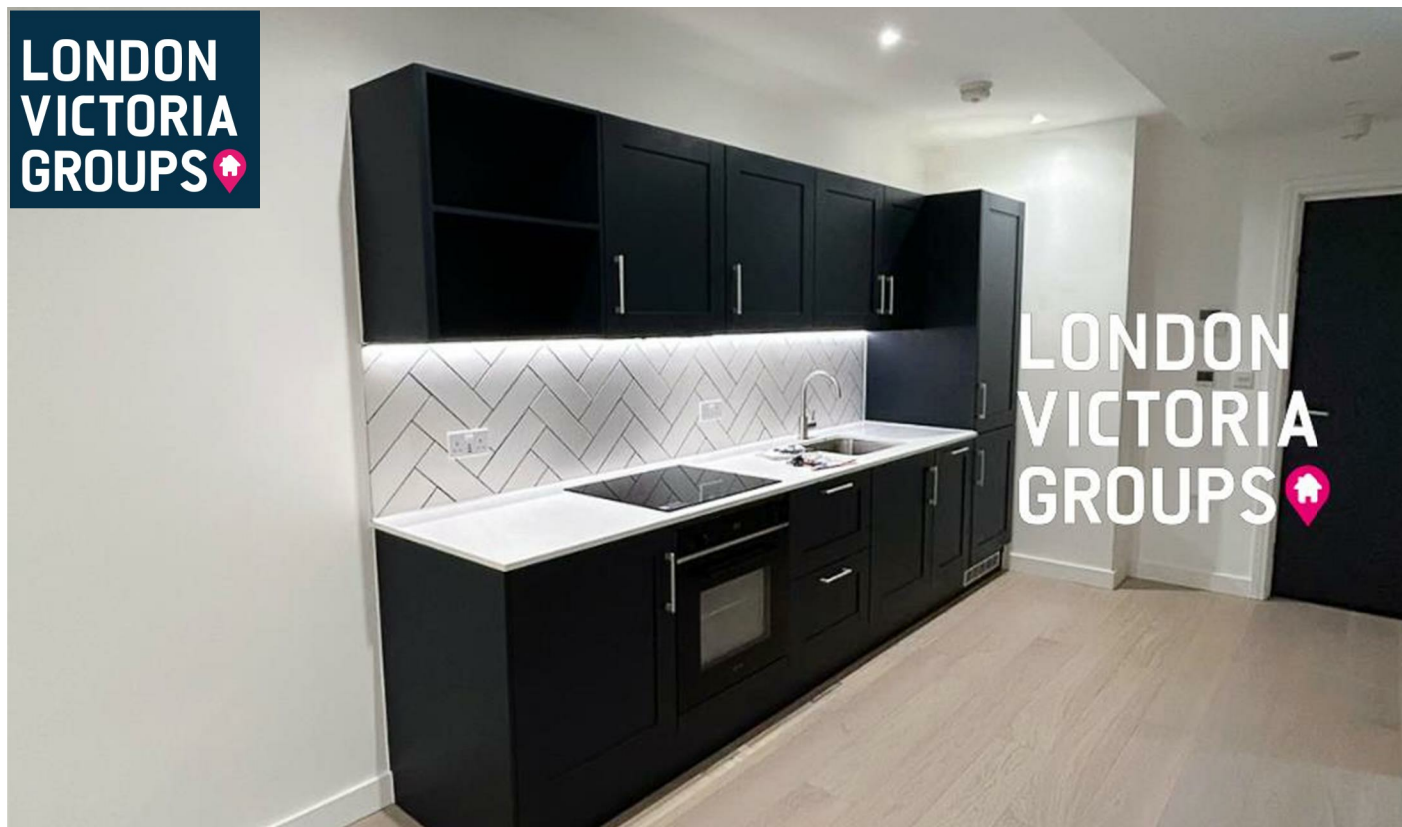

## **Brookline Building, 49 Fulton Road**

, Wembley HA9 0DY

- 24-hour concierge and welcoming lobby
  - Heated swimming pool
  - Spa and Yoga studio
- Golf simulator and games room
  - CTB-A
- Co-working spaces
- Fully equipped gym
  - Private cinema
  - EPC-C

**£2,050 Per Month**

Local Authority **Brent**  
Council Tax Band **C**  
EPC Rating **B**

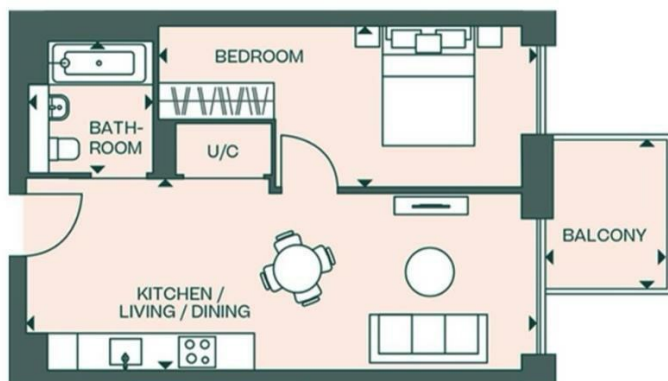

**London Office Office**  
Spaces Victoria, 25 Wilton Road, Pimlico,  
London, SW1V 1LW

**Contact**  
020 3084 3094  
XL@londonvictoriagroups.co.uk  
www.londonvictoriagroups.co.uk

#### 4th Floor

**Internal Area**  
46.2 sq m | 497.1 sq ft

**External Area**  
5.0 sq m | 53.8 sq ft

**Living/Kitchen**  
3.1 x 8.3 m | 10' 3" x 27' 3"

**Bedroom**  
2.6 x 6.1 m | 8' 7" x 20' 3"

**Bathroom**  
2.1 x 2.0 m | 7' 0" x 6' 8"

**Balcony**  
2.5 x 2.0 m | 8' 2" x 6' 7"

Agents Note: Whilst every care has been taken to prepare these particulars, they are for guidance purposes only. All measurements are approximate and for general guidance purposes only and whilst every care has been taken to ensure accuracy, they should not be relied upon and potential buyers/tenants are advised to recheck the measurements.

